



JERRICO ASSOCIATES
 SUITE 27
 77 MARK DRIVE
 SAN RAFAEL, CA 94903

7184 ✓

CORNER RECORD

Document Number 25-171-08

City of Corte Madera County of Marin, California

Brief Legal Description Lot 5 Map of Chapman Woods 8 RM 62

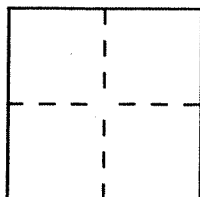

CORNER TYPE

Government Corner Control
 Meander Property
 Rancho Other
 Date of Survey Feb. 13, 1996

**COORDINATES
(Optional)**

N. _____
 E. _____
 Zone _____ Datum _____
 Elev. _____

Corner — Left as found Found and tagged Established Reestablished Rebuilt

Identification and type of corner found: Evidence used to identify or procedure used to establish or reestablish the corner:

■ = Found points along Southerly line of Lot 5
 as shown in Map of Altick Oaks :: Northerly line of Lot A and B
 12 RM 73

A description of the physical condition of the monument as found and as set or reset: _____

(A) (B) Set #5 rebar and cap LS 3887

SURVEYOR'S STATEMENT

This Corner Record was prepared by me or under my direction in conformance with the Land Surveyors' Act on February 13, 1996.

Signed [Signature] L.S. or R.C.E. Number LS 3887

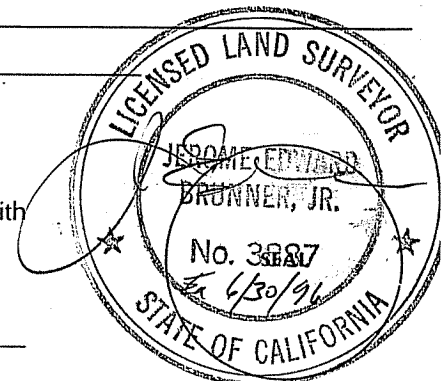

COUNTY SURVEYOR'S STATEMENT

This Corner Record was received February 26 1996 and examined and filed 2-28 1996.

Signed [Signature] Title DES

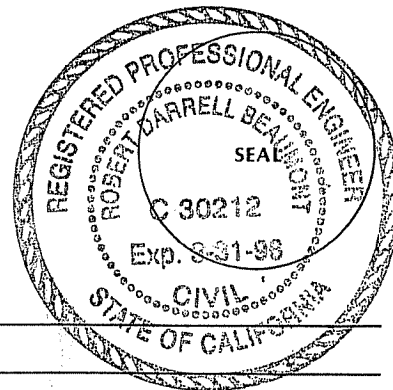

County Surveyor's Comment _____

CHAPMAN

DR. R.M. 8-62

Map of Chapman Woods, RMBk 8-62

Altick Oaks, R.M. Bk. 12-Pg. 115

ALTA WAY

SAUSALITO R.M. 3-24

R.M. 2-73
R.M. 3-24

ST.

