

CORNER RECORD

Document Number A.P. # 25-121-33

TOWN CORTE MADERA
City of CORTE MADERA

County of MARIN, California

Brief Legal Description LOT # 3, RE-SUBDIVISION OF GRACE COURT, CORTE MADERA
CALIFORNIA, 12 R.M. 108

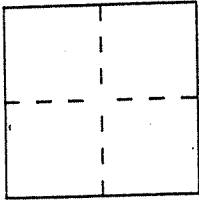

CORNER TYPE

Government Corner Control
Meander Property
Rancho Other
Date of Survey 5/93

COORDINATES (Optional)

N. _____
E. _____
Zone _____ Datum _____
Elev. _____

Corner — Left as found Found and tagged Established Reestablished Rebuilt

Identification and type of corner found: Evidence used to identify or procedure used to establish or reestablish the corner:
FOUND HUB AND TAG, RCE 12247, REPLACED WITH 3/4" IP, CAPPED "LS6234
NOTE THIS WORK WAS DONE UNDER CONTRACT WITH ED GARDNER, LS 3771 AND UNDER
HIS SUPERVISION.. CORNERS SHOWN WERE INADVERTENTLY CAPPED WITH "LS6234"
BY MISTAKE. NO RECORDS ARE KEPT OF THIS CONTRACT WORK IN THIS OFFICE.

A description of the physical condition of the monument as found and as set or reset: _____
HUBS FOUND WITH TAG INTACT. SET 3/4" IP's

SURVEYOR'S STATEMENT

This Corner Record was prepared by me or under my direction in conformance with
the Land Surveyors' Act on APRIL 29 1997.

Signed [Signature] L.S. or R.C.E. Number PLS6234

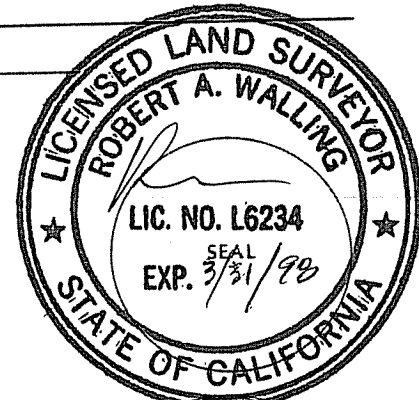

COUNTY SURVEYOR'S STATEMENT

This Corner Record was received MAY 13 1997 and examined
and filed MAY 14 1997.

Signed John M. Wooley Title DEPUTY



County Surveyor's Comment _____

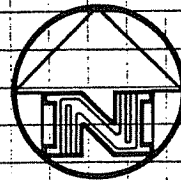

GRACE COURT

15' 53" E.

LOT 1

LOT 4

12 RM 108

20'

N 32° 20' E
47.37'

N 53° 17' W
85.79'

N 79° 07' 10" W
46.447'

S 4° 27' W
54.027'

ROADWAY

EASEMENT

LOT 2

LOT 3

N 6° 09' E
116.260'

48.00'

39.746'

S 3° 28' E
53.028'

140.00'

N 07° 32' E SET 3/4" I.P.
CAP "LS6234"

149.439
289.439'

SET 3/4" I.P.
CAP "LS6234"

PLAN

N.T.S.