



JERRICO ASSOCIATES

SUITE 27
77 MARK DRIVE
SAN RAFAEL, CA 94903

7137 ✓

CORNER RECORD

Document Number 25-066-10

City of Corte Madera County of Marin, California

Brief Legal Description Lot 14A Block B Amended map of portion of block
B,C,D Madera Park Tract 6 RM 56

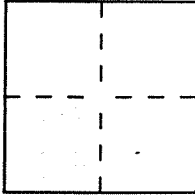

CORNER TYPE

Government Corner Control
 Meander Property
 Rancho Other
 Date of Survey May 15, 1995

COORDINATES (Optional)

N. _____
 E. _____
 Zone _____ Datum _____
 Elev. _____

Corner — Left as found Found and tagged Established Reestablished Rebuilt

Identification and type of corner found: Evidence used to identify or procedure used to establish or reestablish the corner:

(A) Found 1/2" IP and nail. (B) Found nail (C) Found nail and sm/sh
Centerline control nails (by others).

A description of the physical condition of the monument as found and as set or reset:

(D) Set nail/tag LS 3887 in conc. base of steel fc.post (E) Set nail/tag
on top/fc. runner. (F) Set nail/tag on top/fc. railing.
(G) (H) (I) Set #5 rebar and cap LS 3887

SURVEYOR'S STATEMENT

This Corner Record was prepared by me or under my direction in conformance with
 the Land Surveyors' Act on May 15 1995.

Signed [Signature] L.S. or R.C.E. Number LS 3887

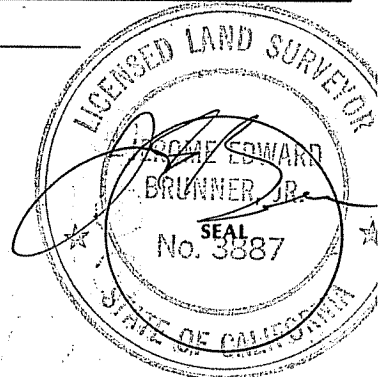

COUNTY SURVEYOR'S STATEMENT

This Corner Record was received 5-24 1995 and examined
 and filed 5-24 1995.

Signed [Signature] Title PLS

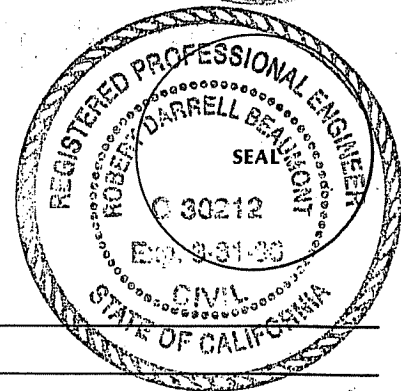

County Surveyor's Comment _____

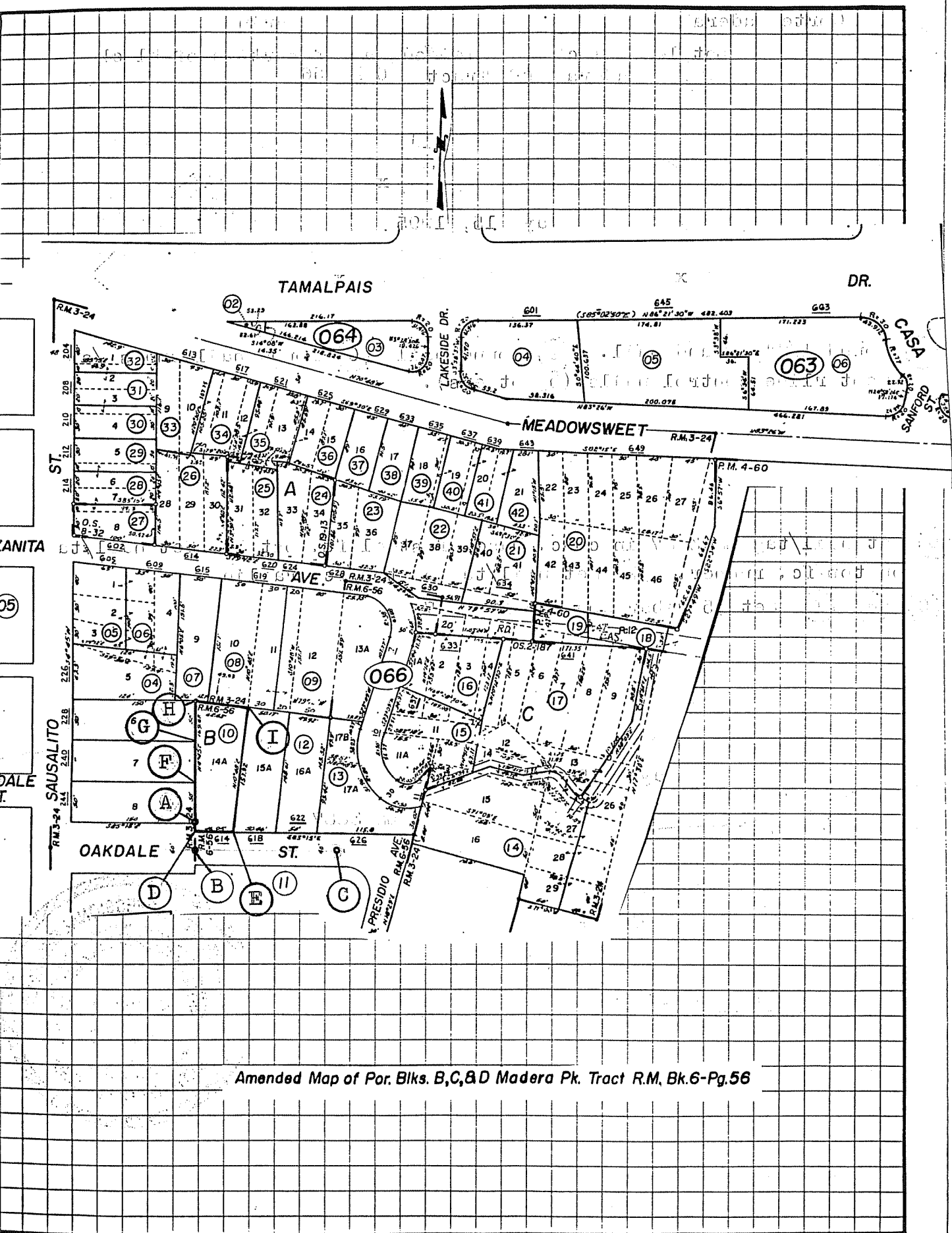

Amended Map of Por. Blks. B,C,&D Madera Pk. Tract R.M. Bk.6-Pg.56