

CORNER RECORD

Document Number APN 25-024-05

City of Corte Madera

County of _____, California

Brief Legal Description lots 8-9-10, Block 'G', 3 RM 76, APN 25-024-05

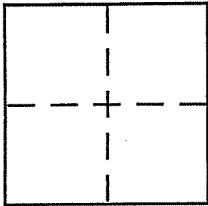

CORNER TYPE

Government Corner Control
Meander Property
Rancho Other
Date of Survey _____

COORDINATES (Optional)

N. _____
E. _____
Zone _____ NAD27 NAD83
NAD83 Epoch _____
Elev. _____
Vert. Datum: NGVD29 NAVD88
Meas. Units: Metric Imperial

Corner -- Left as found Found and tagged Established Reestablished Rebuilt

Identification and type of corner found: Evidence used to identify or procedure used to establish or reestablish the corner:

Set southerly line of the lands of Diebold, being the northerly line of the lands of Wilson, and the southerly line of Lot 10, Blk G, 3RM 76 as said line is shown on 2000 Maps 46. Used found points of 2000 MAP 46 as survey base.

A description of the physical condition of the monument as found and as set or reset: _____

See Back

SURVEYOR'S STATEMENT

This Corner Record was prepared by me or under my direction in conformance with the Land Surveyor's Act on Nov 13 2006

Signed Michael A. Brogan P.L.S or R.C.E. No. LS 5767

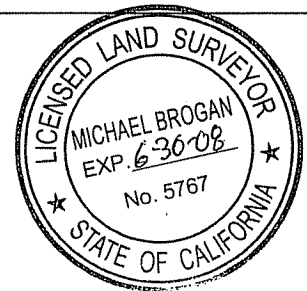

COUNTY SURVEYOR'S STATEMENT

This Corner Record was received DECEMBER 28, 2006 and examined and filed JANUARY 24, 2007

Signed [Signature] P.L.S or R.C.E. No. 7128
Title COUNTY SURVEYOR



County Surveyor's Comment _____

