

# CORNER RECORD

Document Number APN:025-011-09

City of CORTE MADERA County of Marin State of California.

Brief Legal Description: LANDS OF SAULENAS AS PER D. N. 02-117920 & SHOWN ON 2010 OS 53.

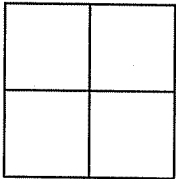

**CORNER TYPE:**

Government Corner  Control   
Meander  Property   
Rancho  Other   
Date of Survey Dec. 2011

**COORDINATES:**

[Optional]  
N> \_\_\_\_\_  
E> \_\_\_\_\_  
Zone \_\_\_\_\_ Datum \_\_\_\_\_  
Elev> \_\_\_\_\_

CORNER: ----- Left as found  Found & Tagged  Established  Reestablished  Rebuilt

Identification & Type of Corner Found: Evidence used to identify or procedure used to establish or reestablish the corner:

FOUND MONUMENTS PER 2010 OS 53 as shown on reverse. Reset Nail & Tag RCE 18200 in sidewalk, back of curb.

A description of the physical condition of the monument as found and as set or reset:

**Original corners per 2010 OS 53 found unreadable, set points in sidewalk back of curb as shown on reverse.**



**SURVEYOR'S STATEMENT:**

The corner record was prepared by me or under my direction in conformance with the Land Surveyors' Act on March 13, 2012

Signed: Douglas J. Matteson RCE# 18200

**COUNTY SURVEYORS STATEMENT:**

This corner record was received: FEBRUARY 8, 2012

and filed MARCH 14, 2012

Signed: [Signature] Title: COUNTY SURVEYOR

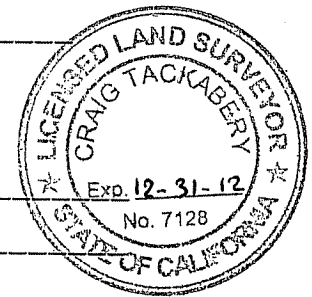

COUNTY SURVEYOR'S COMMENT \_\_\_\_\_  
\_\_\_\_\_  
\_\_\_\_\_

- NOTES:
1. THE BASIS OF BEARING FOR THIS SURVEY IS S 40° 30' 00" E AS MEASURED BETWEEN BACKS OF CURB ON CORTE MADERA AVE, PER 2010 OS 53
  2. DISTANCES ARE IN FEET AND DECIMALS THEREOF.

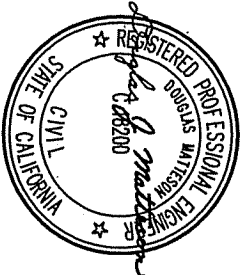
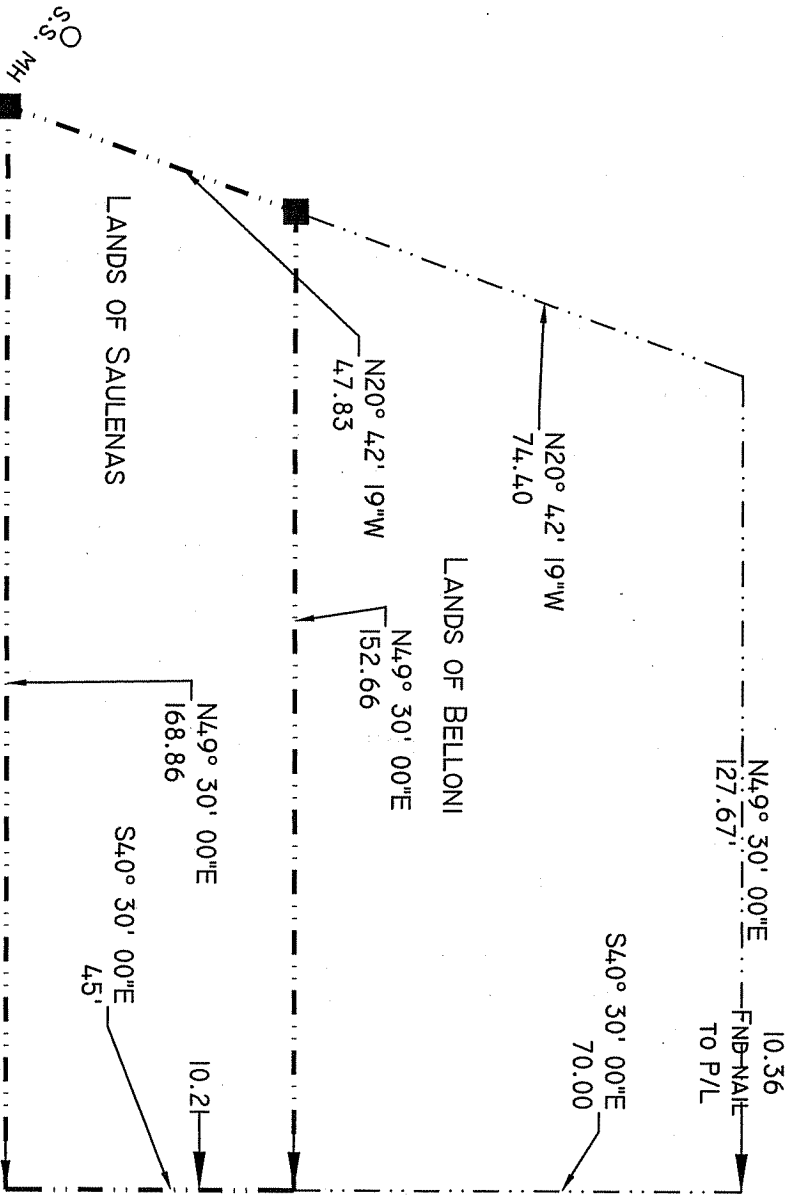

**D MATTESON CIVIL ENGINEER**  
 5 HERON CT, SAN RAFAEL, CA 94901

- SET N&T RCE 18200  
 ■ FOUND5/8" REBAR & CAP RCE 18200 PER 2010-OS 53  
 --- SURVEY BOUNDARY

**LEGEND**

SCALE: 1"=30'

SET NAIL & TAG RCE 18200 @ 10.21' X 2' OFFSET TO P/L.



FND N&T R.C.E. 3230  
 AS SHOWN ON 2010 OS 53  
 BASIS OF BEARING PER 2010 OS 53  
 BACK OF CURB LINE  
 CORTE MADERA AVE.  
 SET N&T RCE 18200 10.21' O/S TO COR.  
 2.00'