

CORNER RECORD

Document Number A.P.N. 020-064-10

City of LARKSPUR

County of MARIN, California

Brief Legal Description LOT 16, BLOCK "A" PER 4 RM 73

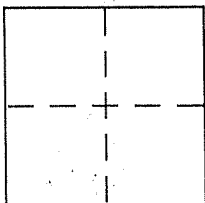

CORNER TYPE

Government Corner Control
Meander Property
Rancho Other
Date of Survey 7-29-03

COORDINATES (Optional)

N. _____
E. _____
Zone _____ NAD27 NAD83
NAD83 Epoch _____
Elev. _____
Vert. Datum: NGVD29 NAVD88
Meas. Units: Metric Imperial

Corner - Left as found Found and tagged Established Reestablished Rebuilt

Identification and type of corner found: Evidence used to identify or procedure used to establish or reestablish the corner:

=SEE OVER=

A description of the physical condition of the monument as found and as set or reset: SET 1/2"
REBAR & CAP AT REAR ANGLE POINT OF LOT 16,
THE ONLY CORNER OF THIS LOT NOT ALREADY
SET OR FOUND PER 2001 MAPS 127
=SEE OVER=

SURVEYOR'S STATEMENT

This Corner Record was prepared by me or under my direction in conformance with
the Land Surveyor's Act on JANUARY 31 2004
Signed David Contreras (P.L.S. or R.C.E. No. 5065)

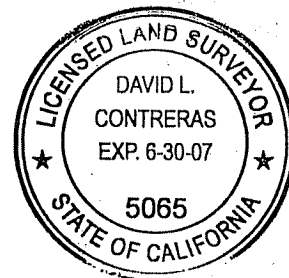

COUNTY SURVEYOR'S STATEMENT

This Corner Record was received FEBRUARY 11, 2004
and examined and filed MARCH 4, 2004
Signed Ce P.L.S. or R.C.E. No. 7128
Title COUNTY SURVEYOR

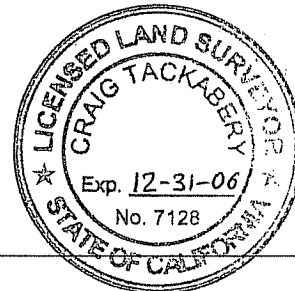

County Surveyor's Comment _____

4 R.M. 73
BLOCK "C"

LEGEND

- = FOUND 2"x2" REDWOOD HUB & TAG, L.S. 2738
- = SET 1/2" REBAR & PLASTIC CAP, L.S. 5065
- ★ = FOUND NAIL & TAG, L.S. 5065, IN SOUTHWESTERLY BASE OF 20" WHITE OAK.
- N.T.S. = NOT TO SCALE
- = FOUND 1/2" REBAR & CAP L.S. 5065

ARBOR

ST. 50'

MURRAY AVE.

N 52° 11' E

FOUND 10" SQUARE CONCRETE MONUMENT WITH PIN (R1)

HELD
575° 22' E
44.95'
TIE PER R1

1" = 40'

2001 PAGE
MAPS 1273

FOUND 3/4" IRON PIPE, WOOD PLUG & TAG L.S. 2731
145.69'
559° 43' 20" E

FOUND 1/2" IRON PIPE, CONCRETE PLUG & TAG, RCE 13639 (TYPICAL)

NOTES

- R1 = DATA PER 4 R.M. 73
- R2 = DATA PER 3 DEEDS 110

MON PER R1 NOT FOUND

N 15° 19' E
403.231' CALC. FROM R1

N 18° 25' E
85.7'

4 R.M. 73
BLOCK "A"

