



JERRICO ASSOCIATES

SUITE 27  
77 MARK DRIVE  
SAN RAFAEL, CA 94903

7414

# CORNER RECORD

Document Number 13-114-32

City of San Rafael

County of Marin, California

Brief Legal Description Parcel 'C' 20 P.M. 99

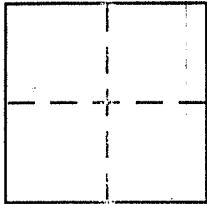

### CORNER TYPE

Government Corner  Control   
 Meander  Property   
 Rancho  Other   
 Date of Survey Nov. 30, 2000

### COORDINATES (Optional)

N. \_\_\_\_\_  
 E. \_\_\_\_\_  
 Zone \_\_\_\_\_ NAD27  NAD83   
 NAD83 Epoch \_\_\_\_\_  
 Elev. \_\_\_\_\_  
 Vert. Datum: NGVD29  NAVD88   
 Meas. Units: Metric  Imperial

Corner -- Left as found  Found and tagged  Established  Reestablished  Rebuilt

Identification and type of corner found: Evidence used to identify or procedure used to establish or reestablish the corner:  
(A) (B) (C) (D) Found points per 20 P.M. 99

A description of the physical condition of the monument as found and as set or reset:  
(V) Set plug/tag LS 3887 in S/W. (W) Set plug/tag LS 3887 in conc. ledge.  
(X) Set rebar/tag LS 3887 wired. (Y) Set rebar and cap LS 3887.  
(Z) Set rebar and cap LS 3887.

### SURVEYOR'S STATEMENT

This Corner Record was prepared by me or under my direction in conformance with the Land Surveyor's Act on November 30, 2000

Signed [Signature] P.L.S. or R.C.E. No. LS 3887

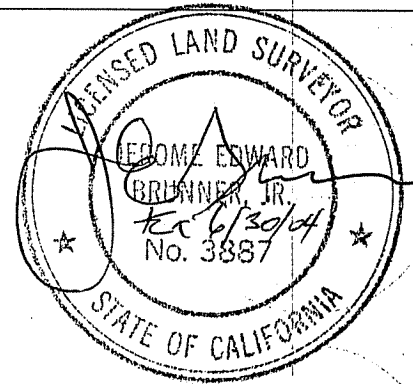

### COUNTY SURVEYOR'S STATEMENT

This Corner Record was received January 9, 2001  
 and examined and filed January 11, 2000

Signed [Signature] P.L.S. or R.C.E. No. 7128  
 Title Deputy

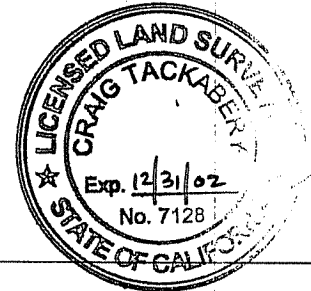

County Surveyor's Comment \_\_\_\_\_

