

# CORNER RECORD

Agency Index CR24-011

Document Number 012-051-12 (ADJ)(b)

City of SAN RAFAEL County of MARIN, California

Brief Legal Description MONUMENT LOCATED WITHIN SECOND STREET AT 1825 SECOND ST

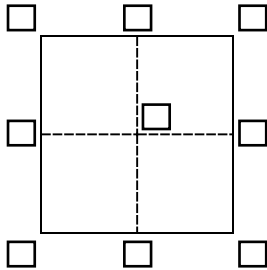

### CORNER TYPE

- Government Corner  Control
- Meander  Property
- Rancho  Other

Date of Survey January 2024

### COORDINATES (Optional)

N. \_\_\_\_\_ E. \_\_\_\_\_

Elevation \_\_\_\_\_

Units  Metric  U.S. Survey Foot

Horizontal Datum \_\_\_\_\_

Zone \_\_\_\_\_ Epoch Date \_\_\_\_\_

Vertical Datum \_\_\_\_\_

Complies with Public Resources Code §§8801-8819

Complies with Public Resources Code §§8890-8902

PLS Act Ref.:  8765(d)  8771  8773  Other:

Corner/  
Monument:  Left as found  Established  Rebuilt  Pre-Construction

Found and tagged  Reestablished  Referenced  Post-Construction

Narrative of corner identified and monument as found, set, reset, replaced, or removed:

See sheet #2 for description(s):

SPIKE AND WASHER AS SHOWN ON PRE-CON CORNER RECORD WAS DESTROYED DURING CONSTRUCTION. SET NAIL AND TAG, IN SIDEWALK, MARKED PLS 9387 TO PRESERVE PREVIOUS MONUMENT LOCATION.

REFERENCE POINTS IN CONCRETE AS SHOWN ON PAGE 2 TO PRESERVE MONUMENT LOCATION.

### SURVEYOR'S STATEMENT

This Corner Record was prepared by me or under my direction in conformance with

the Professional Land Surveyors' Act on January 30, 2024.

Signed [Signature] P.L.S. or R.C.E. No. 9387



### COUNTY SURVEYOR'S STATEMENT

This Corner Record was received January 31, 2024

and examined and filed February 05, 2024.

Signed T.W. Park P.L.S. [Redacted] No. 8176

Title County Surveyor

County Surveyor's Comment



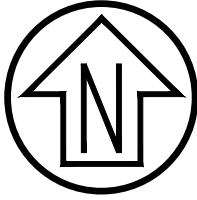

Graphic Scale (in feet)



1 inch = 20 ft.

NAIL AND TAG  
PLS 9387  
IN CONCRETE

NAIL AND TAG  
PLS 9387  
IN CONCRETE

SPIKE AND WASHER AS SHOWN  
ON PRE-CON CORNER RECORD  
WAS DESTROYED DURING  
CONSTRUCTION. NAIL AND TAG  
MARKED PLS 9387 SET TO  
PRESERVE PREVIOUS MONUMENT  
LOCATION.

NAIL AND TAG  
PLS 9387  
IN CONCRETE

LANDS OF CAMPODONICO  
APN:012-051-12  
1825 2ND ST, SAN RAFAEL, CA 94901

EAST STREET

SECOND STREET

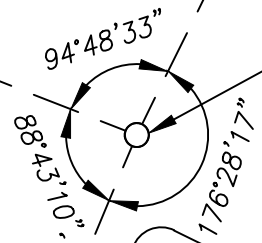

**LEGEND**

- TIE TO PRE-CONSTRUCTION REFERENCE POINT
- ▲ REFERENCE POINT, NAIL AND TAG PLS 9387
- SET MONUMENT AS NOTED

**CSW | ST2**

**CSW/Stuber-Stroch Engineering Group, Inc.**  
 Civil & Structural Engineers | Surveying & Mapping | Environmental Planning  
 Land Planning | Construction Management  
 45 Leveroni Court  
 Novato, CA 94949  
 tel: 415.883.9850  
 fax: 415.883.9835  
<http://www.cswst2.com>

Rev. -  
Job No. 1920101.51

Date: 01/26/24  
Scale: 1" = 20'

**MONUMENT PRESERVATION  
CORNER RECORD**

MONUMENT LOCATED WITHIN SECOND STREET AT 1825 2ND STREET  
 SAN RAFAEL MARIN CALIFORNIA