

DESIGN
WESTON PRE SOUNDINGS TO DESIGN

CHANNEL	ACRES	DESIGN	WESTON VOLUME	OVER DREDGE	WESTON VOLUME	WESTON VOLUME TOTAL	DESIGN	PLS VOLUME	OVER DREDGE	PLS VOLUME	PLS VOLUME TOTAL
SOUTH ENTRANCE CHANNEL	1.04	-8	4,900	-8.5	800	5,700	-8	4,804	-8.5	745	5,549
SOUTH WATERWAY	3.18	-7	7,350	-7.5	2,540	9,890	-7	7,246	-7.5	1,775	9,021
CHANNEL D	1.68	-7	2,450	-7.5	1,360	3,810	-7	2,370	-7.5	1,102	3,472
CHANNEL E	1.07	-7	1,550	-7.5	860	2,410	-7	1,237	-7.5	461	1,698
TOTALS	6.97		16,250		5,560	21,810		15,657		4,083	19,740

WESTON PRE-DREDGE VS PLS SURVEYS POST-DREDGE 12/07/2014
PRE-POST CUT 19,740 CY

- NOTES:
- SOUNDINGS ARE FEET MLLW
 - TIDE CORRECTIONS AND NAVIGATION ARE DETERMINED USING LEICA "VIVA" SURVEY GRADE RTK GPS. NAD 88.
 - BENCHMARK PID NO. 5009 A 1979 17.86 FT MLLW. AND THE BENCH MARK "+" ON E.C. MONUMENT OPPOSITE HOUSE #143 TRINIDAD WAY COUNTY B.M. EL=13.22 MLLW
 - ADDITIONAL SOUNDINGS AND "LEAD LINES" WERE TAKEN ON 01/20/2015.

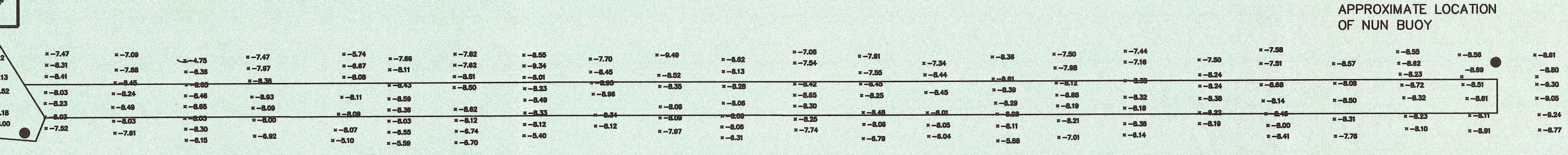

SOUTH ENTRANCE CHANNEL

AS BUILT
REVISIONS BY *Joanna Dixon* RES. ENGR.
DATE CONSTRUCTED 9/23/14 - 12/6/14

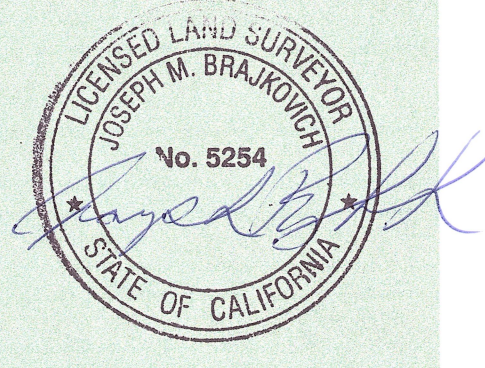

SCALE 1"=80'

NO.	REVISION	ADD SOUNDINGS 1/20/15
1		
2		
3		
4		
5		

PARADISE CAY - CSA NO. 29
USACE PERMIT # 29020N **EPISODE # 3**

TIBURON **SOUTH MARINA DREDGE** **CALIFORNIA**
2014 MAINTENANCE DREDGING POST DECEMBER 07, 2014

PLS Surveys, Inc.
LAND & HYDROGRAPHIC SURVEYORS
2220 Livingston Street, Suite 202
Oakland, California 94608-5203
510.261.0900 FAX 510.261.3503
e-mail: plssur@pacbell.net

DATE	12/20/14
SCALE	1" = 80'
DESIGNER	JMB
JOB NO.	14032
SHEET	1
	OF 1 SHEETS